

**SUPPLEMENT NO.5 TO DOC.NO. CR-MM-1-0-00****IMPROVED CANOPY GUIDANCE DURING CLOSING****LIST OF AIRPLANES COVERED BY THIS SUPPLEMENT**

Airplane model	Serial No.	Note
PS-28 Cruiser and SportCruiser / PiperSport – operating under EASA rules		Minor Change approval No.10067522 15 November 2018



RECORD OF REVISIONS

Rev. No.	Revision name	Changed pages	Issue date	Date and signature



LIST OF EFFECTIVE PAGES

Page	Date	Page	Date	Page	Date
1	2018-10-18				
2	2018-10-18				
3	2018-10-18				
4	2018-10-18				
5	2018-10-18				
6	2018-10-18				



CHAPTER 1 GENERAL

No Change

CHAPTER 2 LIMITATIONS / MAINTENANCE CHECKS

No Change

CHAPTER 3 FUSELAGE

3.2 Description and Operation

3.2.5 Crew canopy

The crew canopy is produced of organic glass and consists of opening canopy and rear fixed canopy windows.

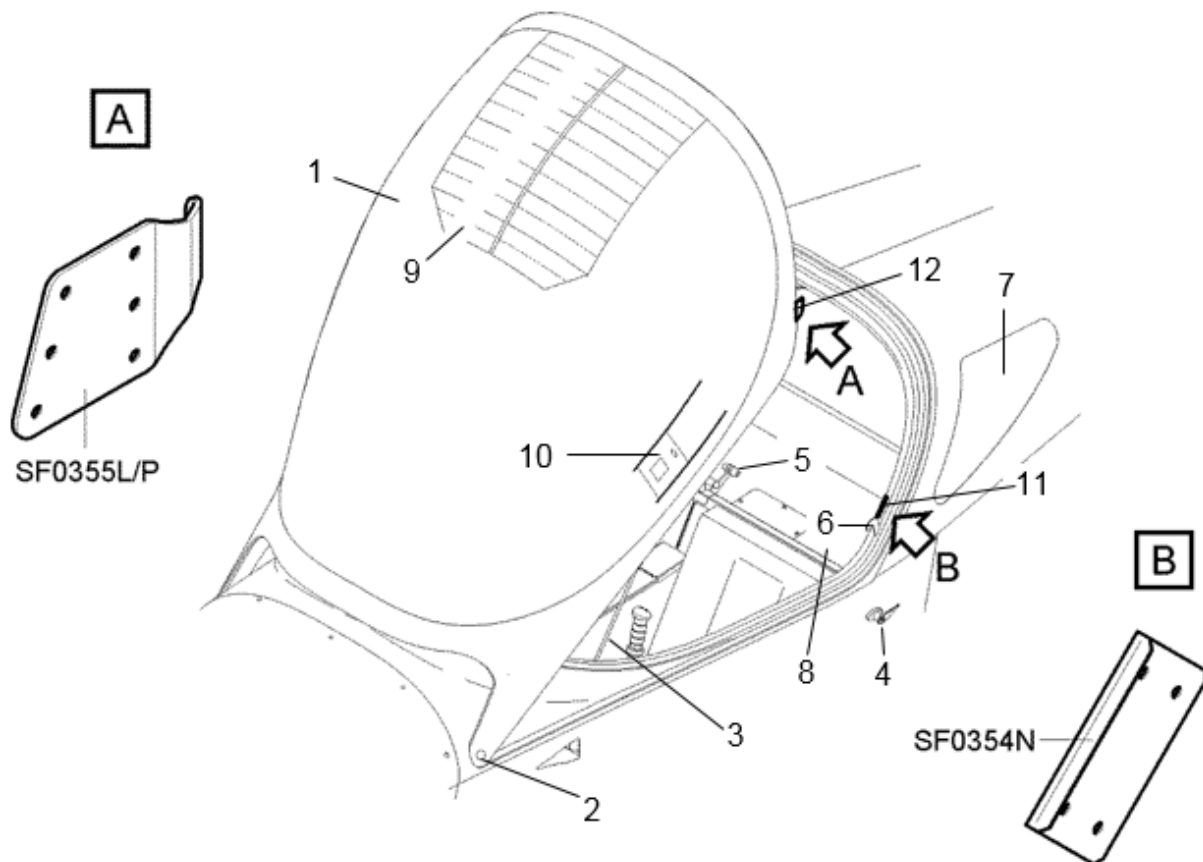

- | | |
|------------------------|------------------------------------|
| 1 Canopy | 7 Rear canopy window |
| 2 Canopy hinge | 8 Baggage compartment |
| 3 Gas strut | 9 Sunshield |
| 4 Canopy lock | 10 Sliding side ventilation window |
| 5 Inside opening lever | 11 Protective metal plate |
| 6 Locking lever | 12 Guiding metal plate |

Fig. 3-3: PS-28 Cruiser canopy



3.2.5.1 Crew canopy

The canopy (1, Fig. 3-3) has a semi drop shape and enables access to the cockpit. The canopy consists of composite frame on which the windscreen is attached. The canopy is suspended in two swivel hinges (2) on front sides of the composite fixed frame. The canopy can be opened forward and is lightened by a gas strut (3) each side which keep it in the opened position. The canopy lock (4) is placed on the left side of fuselage below the cockpit frame. The locking levers (6) are installed inside the fixed frame. The opening lever (5) is placed between the seats backs. The handle (7, Fig. 3-5) is attached on the upper part of the composite frame. Along its whole perimeter, the canopy is sealed with a silicone profile. The canopy is equipped with the sunshield (9, Fig. 3-3) and sliding ventilation windows (10, Fig.3-3) located on both sides of the canopy.

For accurate guidance - centering the canopy into the fixed canopy frame on the fuselage during its closing and locking by the locking hooks, the protective and guiding metal plates (11, 12) is installed on both inner sides of the fixed canopy frame and the tilting canopy.

Closing and securing of the canopy is sensed by one terminal switch, located at the inside opening lever between the seats (see Wiring Manual). If the canopy is not properly closed and secured, the **CABIN OPENED** light will be flashed in red on the upper part of the left instrument panel.

CHAPTER 4 WING

No Change

CHAPTER 5 TAIL UNIT

No Change

CHAPTER 6 CONTROL SYSTEM

No Change

CHAPTER 7 EQUIPMENT

No Change

CHAPTER 8 LANDING GEAR

No Change

CHAPTER 9 FUEL SYSTEM

No Change

CHAPTER 10 POWER UNIT

No Change

CHAPTER 11 ELECTRICAL SYSTEM

No Change

CHAPTER 12 INSTRUMENTS AND AVIONICS

No Change

CHAPTER 13 VENTING / HEATING

No Change



CHAPTER 14 AIRPLANE HANDLING

No Change

CHAPTER 15 AIRPLANE REPAIRS

No Change

CHAPTER 16 WIRING DIAGRAMS

No Change

CHAPTER 17 APPENDICES

No Change